

90° AP..1003/1604

Indexable Brand:ISO

heikenei.com

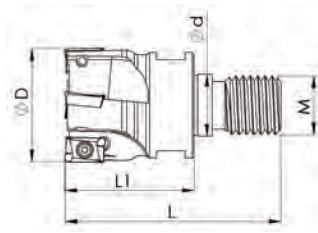

| Item Code | Stock | Inter C | Dimension mm | | | | | | Spare Parts | | | |
|----------------|-------|---------|---------------|---|----|----|------|-----|-------------|--------|-------|------|
| | | | Inter Coolant | D | Z | L1 | L | d | M | Insert | Screw | Torx |
| AP.. 1003/1604 | Stock | | | | | | | | | | | |
| HEI.1191200 | • | ○ | 25 | 3 | 38 | 60 | 12.5 | M12 | AP..1003 | M2,5X7 | T08 | |
| HEI.1191300 | • | ○ | 32 | 4 | 36 | 60 | 17 | M16 | AP..1003 | M2,5X7 | T08 | |
| HEI.1191400 | • | ○ | 35 | 4 | 36 | 60 | 17 | M16 | AP..1003 | M2,5X7 | T08 | |
| HEI.1191500 | • | ○ | 35 | 5 | 36 | 60 | 17 | M16 | AP..1003 | M2,5X7 | T08 | |
| HEI.1191600 | • | ○ | 40 | 5 | 36 | 60 | 17 | M16 | AP..1003 | M2,5X7 | T08 | |
| HEI.1191700 | • | ○ | 42 | 5 | 36 | 60 | 17 | M16 | AP..1003 | M2,5X7 | T08 | |
| HEI.1191180 | • | ○ | 16 | 2 | 33 | 50 | 8.5 | M08 | AP..1003 | M2,5X7 | T08 | |
| HEI.1191190 | • | ○ | 20 | 3 | 32 | 51 | 10.5 | M10 | AP..1003 | M2,5X7 | T08 | |
| HEI.1191800 | • | ○ | 25 | 2 | 38 | 60 | 12.5 | M12 | AP..1604 | M3,5X9 | T15 | |
| HEI.1191900 | • | ○ | 32 | 3 | 44 | 68 | 17 | M16 | AP..1604 | M3,5X9 | T15 | |
| HEI.1192000 | • | ○ | 40 | 4 | 44 | 68 | 17 | M16 | AP..1604 | M3,5X9 | T15 | |

90° APMT 11T3

Indexable Brand:ISO

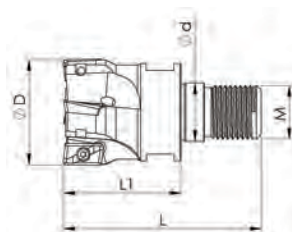

| Item Code | Stock | Inter C | Dimension mm | | | | | | Spare Parts | | | |
|-------------|-------|---------|---------------|---|----|----|------|-----|-------------|--------|-------|------|
| | | | Inter Coolant | D | Z | L1 | L | d | M | Insert | Screw | Torx |
| APMT 11T3 | Stock | | | | | | | | | | | |
| HEI.1192100 | • | ○ | 20 | 3 | 31 | 50 | 10.5 | M10 | APMT 11T3 | M2,5X7 | T8 | |
| HEI.1192200 | • | ○ | 25 | 3 | 29 | 50 | 12.5 | M12 | APMT 11T3 | M2,5X7 | T8 | |
| HEI.1192300 | • | ○ | 25 | 4 | 29 | 50 | 12.5 | M12 | APMT 11T3 | M2,5X7 | T8 | |
| HEI.1192400 | • | ○ | 32 | 4 | 36 | 60 | 17 | M16 | APMT 11T3 | M2,5X7 | T8 | |
| HEI.1192500 | • | ○ | 40 | 5 | 36 | 60 | 17 | M16 | APMT 11T3 | M2,5X7 | T8 | |