

PWLNR

Indexable Compability: ISO

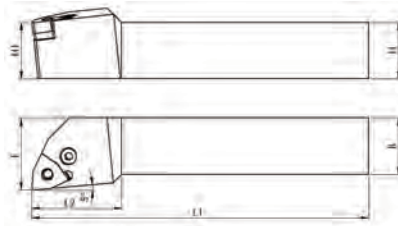

Item Code	Stock		Dimension mm								Spare Parts					
	R	L	H1	H	B	F	L1	L2	λF	γ0	Insert	Shim	Screw	Crowbar	Metal Sheet	Key
HEI.1051136	•	•	20	20	25	125	35	-6	-6	WNM0.0804..	WN..08 (H)	MPV M8 U	MPL 012	MPS 012	A3	
HEI.1051138	•	•	25	25	32	150	40	-6	-6	WNM0.0804..	WN..08 (H)	MPV M8 U	MPL 012	MPS 012	A3	
HEI.1051140	•	•	32	32	32	170	40	-6	-6	WNM0.0804..	WN..08 (H)	MPV M8 U	MPL 012	MPS 012	A3	
HEI.1051142	•	•	40	40	25	200	45	-6	-6	WNM0.0804..	WN..08 (H)	MPV M8 U	MPL 012	MPS 012	A3	

PTJNR

Indexable Compability: ISO

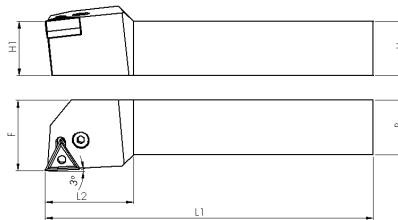

Item Code	Stock		Dimension mm								Spare Parts					
	R	L	H1	H	B	F	L1	L2	λF	γ0	Insert	Shim	Screw	Crowbar	Metal Sheet	Key
HEI.1051144	○	○	20	20	25	125	35	-6	-6	TNMG 1604	TN..16 (H)	MPV M8 U	MPL 011	MPS 011	A3	
HEI.1051146	○	○	25	25	32	150	40	-6	-6	TNMG 1604	TN..16 (H)	MPV M8 U	MPL 011	MPS 011	A3	
HEI.1051148	○	○	32	32	40	170	40	-6	-6	TNMG 1604	TN..16 (H)	MPV M8 U	MPL 011	MPS 011	A3	
HEI.1051150	•	•	25	25	32	150	40	-6	-6	TNMG 2204	TN..022 (H)	MPV M8 U	MPL 012	MPS 012	A3	
HEI.1051152	•	•	32	32	40	170	40	-6	-6	TNMG 2204	TN..022 (H)	MPV M8 U	MPL 012	MPS 012	A3	
HEI.1051154	○	○	40	40	50	200	45	-6	-6	TNMG 2204	TN..022 (H)	MPV M8 U	MPL 012	MPS 012	A3	