

# SCNCN

Indexable Compability: ISO

heikenei.com

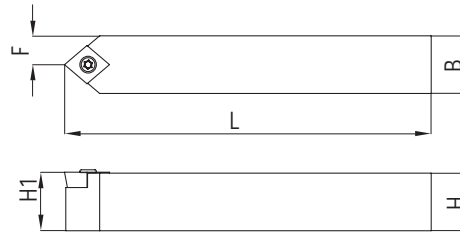

Item Code	Stock	Dimension mm								Spare Parts				
		H1	H	B	F	L1	L2	$\lambda S$	$\gamma 0$	Insert	Shim	Screw	Screw	Torx
HEI.1030800	•	8	8	4	100	16	0	0	CC.T 0602..	-	-	M2,5X7	T08	
HEI.1030900	•	10	10	5	100	16	0	0	CC.T 0602..	-	-	M2,5X7	T08	
HEI.1031000	•	16	16	8	100	25	0	0	CC.T 09T3..	-	-	M4X12	T15	
HEI.1031100	•	20	20	10	125	35	0	0	CC.T 1204..	CC..012	M6XM4	M3,5X14	T15	
HEI.1031200	•	25	25	12.5	150	40	0	0	CC.T 1204..	CC..012	M6XM4	M3,5X14	T15	
HEI.1031300	•	12	12	6	100	20	0	0	CC.T 0602..	-	-	M2,5X7	T15	
HEI.1031400	•	12	12	6	150	40	0	0	CC.T 09T3..	-	-	M3,5X11	T15	

# SRGCR

Indexable Compability: ISO

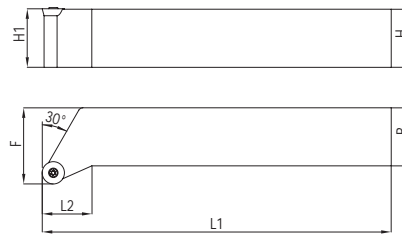

Item Code	Stock	Dimension mm								Spare Parts			
		R	L	H1	H	B	F	L1	L2	$\lambda S$	$\gamma 0$	Insert	Screw
HEI.1031500	•	•	16	16	21	125	25	0	0	RC.T 0803..	M3X9	T10	
HEI.1031600	•	•	20	20	25	125	35	0	0	RC.T 0803..	M3X9	T10	
HEI.1031700	•	•	25	25	32	150	40	0	0	RC.T 0803..	M3X9	T10	
HEI.1031800	•	•	16	16	21	100	25	0	0	RC.T 10T3..	M4X11	T15	
HEI.1031900	•	•	20	20	25	125	35	0	0	RC.T 10T3..	M4X11	T15	
HEI.1032000	•	•	25	25	32	150	40	0	0	RC.T 10T3..	M4X11	T15	
HEI.1032100	•	•	32	32	40	170	40	0	0	RC.T 10T3..	M4X11	T15	
HEI.1032200	•	•	16	16	21	100	25	0	0	RC.T 1204..	M4X11	T15	
HEI.1032300	•	•	20	20	25	125	35	0	0	RC.T 1204..	M4X11	T15	
HEI.1032400	•	•	25	25	32	150	40	0	0	RC.T 1204..	M4X11	T15	
HEI.1032500	•	•	32	32	40	170	40	0	0	RC.T 1204..	M4X11	T15	