

Aufsteckfräser 90° / AP.. 16
Face milling cutter 90° / AP.. 16

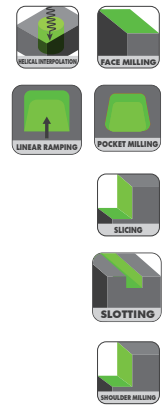

Abmessungen [mm] Dimensions [mm]						Artikelbezeichnung Item Code	Bestell-Nr. Order No	Verfüg. Availability	Ersatzteile Spare parts		
D _C	d _A	d _I	h	a _p	z				Spannschraube Fastening screw HKE02-51206 5002600 MA = 3Nm	Torx-Schlüssel Torque wrench IP15 5001100	
40	16	32	40	15	4	HMF90 AP16.040 Z04	2234000	•			
50	22	42	40	15	5	HMF90 AP16.050 Z05	2234100	•			
63	22	48	40	15	6	HMF90 AP16.063 Z06	2234200	•			
80	27	58	50	15	7	HMF90 AP16.080 Z07	2234300	•			
100	32	76	50	15	8	HMF90 AP16.100 Z08	2234400	•			
125	40	90	63	15	9	HMF90 AP16.125 Z09	2234500	•			

Aufsteckfräser 90° / AP.. 16 / INCH
Face milling cutter 90° / AP.. 16 / INCH

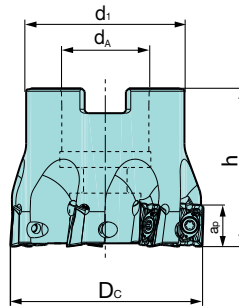
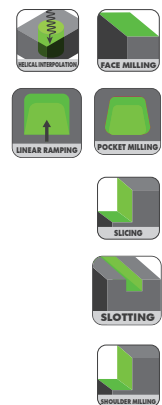
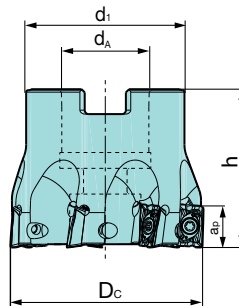

Abmessungen [INCH] Dimensions [INCH]						Artikelbezeichnung Item Code	Bestell-Nr. Order No	Verfüg. Availability	Ersatzteile Spare parts		
D _C	d _A	d _I	h	a _p	z				Spannschraube Fastening screw HKE02-51206 5002600 MA = 3Nm	Torx-Schlüssel Torque wrench IP15 5001100	
2.0	0.75	1.75	1.50	0.590	5	HMFU90 AP16.2000 Z05-INCH	2251200	○			
2.5	1.00	2.25	1.75	0.590	6	HMFU90 AP16.2500 Z06-INCH	2251300	○			
3.0	1.00	2.25	1.75	0.590	7	HMFU90 AP16.3000 Z07-INCH	2251400	○			
4.0	1.50	3.75	2.25	0.590	8	HMFU90 AP16.4000 Z08-INCH	2251500	○			
5.0	1.50	3.75	2.50	0.590	9	HMFU90 AP16.5000 Z09-INCH	2251600	○			