

Aufsteckfräser 45° / ON.. 08 / INCH
Face milling cutter 45° / ON.. 08 / INCH

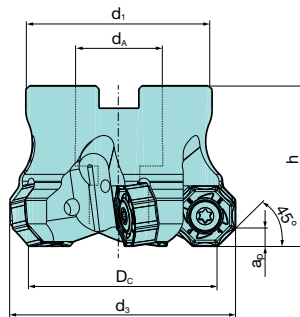
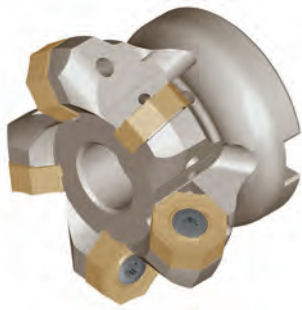

Abmessungen [INCH] Dimensions [INCH]							Artikelbezeichnung Item Code	Bestell-Nr. Order No	Verfüg. Availability	Ersatzteile Spare parts	
D _C	d ₃	d _A	d ₁	h	a _p	z					
2.0	2.4	0.75	2.00	2.00	0.197	4	HMFU45 ON08.2000 Z04-INCH	2247100	o	Spannschraube Fastening screw HK02-71271 5001600 MA = 6Nm	Torx-Schlüssel Torque wrench T25 5000500
2.5	2.9	1.00	2.25	2.00	0.197	5	HMFU45 ON08.2500 Z05-INCH	2247200	o		
3.0	3.4	1.25	2.75	2.00	0.197	6	HMFU45 ON08.3000 Z06-INCH	2247300	o		
3.0	3.4	1.25	2.75	2.00	0.197	7	HMFU45 ON08.3000 Z07-INCH	2247400	o		
4.0	4.4	1.50	3.75	2.25	0.197	7	HMFU45 ON08.4000 Z07-INCH	2247500	o		
4.0	4.4	1.50	3.75	2.25	0.197	9	HMFU45 ON08.4000 Z09-INCH	2247600	o		
5.0	5.4	1.50	3.75	2.50	0.197	9	HMFU45 ON08.5000 Z09-INCH	2247700	o		
5.0	5.4	1.50	3.75	2.50	0.197	11	HMFU45 ON08.5000 Z11-INCH	2247800	o		
6.0	6.4	2.00	5.00	2.00	0.197	11	HMFU45 ON08.6000 Z11-INCH	2247900	o		

Bild & Zeichnung Image & Drawings	Artikelbezeichnung Item Code	Schneidstoffsorte Cutting materials	Bestell-Nr. Order No	Verfüg. Availability	Abmessungen [mm] Dimensions [mm]				
					l	d	s	d ₁	r
<p>N = 16</p>	■ ONMQ 0806 SW	HAM35M	2178500	=	8	19,1	6,95	6,75	0,8
	■ ONMQ 0806 SW	HAH03M	2178300	=	8	19,1	6,95	6,75	0,8
	■ ONMQ 0806 SW	HAH10M	2178400	=	8	19,1	6,95	6,75	0,8
<p>N = 8</p>	■ ONMU 080608 TM-NR	HAP20M	2179800	=	8	19	6,95	6,75	0,8
	■ ONMU 080608 TM-NR	HAP25M	2179900	=	8	19	6,95	6,75	0,8
	■ ONMU 080608 TM-NR	HAP30M	2180000	=	8	19	6,95	6,75	0,8
	■ ONMU 080608 TM-NR	HAP35M	2180100	=	8	19	6,95	6,75	0,8
	■ ONMU 080608 TM-NN	HAM35M	2179600	=	8	19	6,95	6,75	0,8
	■ ONMU 080608 TM-NN	HAM40M	2179700	=	8	19	6,95	6,75	0,8
	■ ONMU 080608 TM-NK	HAK15M	2179400	=	8	19	6,95	6,75	0,8
	■ ONMU 080608 TM-NK	HAK20M	2179500	=	8	19	6,95	6,75	0,8