

Aufsteckfräser 45° / ON.. 05
Face milling cutter 45° / ON.. 05

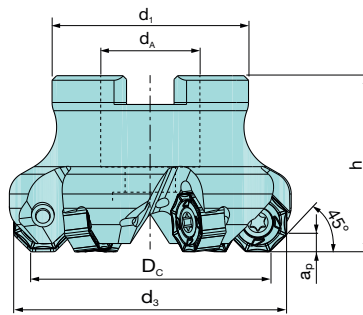

Compatible with
ONMU 05 & SNMX 12
indexable inserts



Abmessungen [mm] Dimensions [mm]							Artikelbezeichnung Item Code	Bestell-Nr. Order No	Verfüg. Availability	Ersatzteile Spare parts	
Dc	d3	dA	d1	h	α _p	z					
50	57,5	22	50	40	3	4	HMF45 ON05.050 Z04	2222100	=	Spann- schraube Fastening screw HKE06-51226 5002800 MA = 5Nm	Torx- Schlüssel Torque wrench IP20 5001200
50	57,5	22	50	40	3	6	HMF45 ON05.050 Z06	2222200	=		
63	70,5	22	50	40	3	6	HMF45 ON05.063 Z06	2222300	=		
63	70,5	22	50	40	3	8	HMF45 ON05.063 Z08	2222400	=		
80	87,5	27	60	50	3	7	HMF45 ON05.080 Z07	2222500	=		
80	87,5	27	60	50	3	10	HMF45 ON05.080 Z10	2222600	=		
100	107,5	32	80	50	3	8	HMF45 ON05.100 Z08	2222700	=		
100	107,5	32	80	50	3	12	HMF45 ON05.100 Z12	2222800	=		
125	132,5	40	95	63	3	10	HMF45 ON05.125 Z10	2222900	=		
125	132,5	40	95	63	3	16	HMF45 ON05.125 Z16	2223000	=		

Aufsteckfräser 45° / ON.. 05 / INCH
Face milling cutter 45° / ON.. 05 / INCH

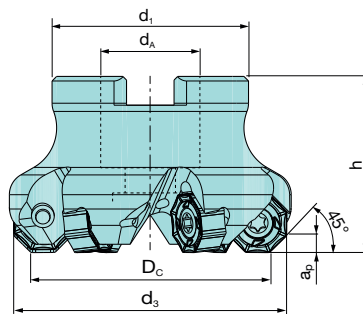

Compatible with
ONMU 05 & SNMX 12
indexable inserts



Abmessungen [INCH] Dimensions [INCH]							Artikelbezeichnung Item Code	Bestell-Nr. Order No	Verfüg. Availability	Ersatzteile Spare parts	
Dc	d3	dA	d1	h	α _p	z					
2.1	2.25	0.75	2.00	1.45	0.118	4	HMFU45 SN12.2000 Z04-INCH	2248200	o	Spann- schraube Fastening screw HKE06- 51226 5002800 MA= 5Nm	Torx- Schlüssel Torque wrench IP20 5001200
2.1	2.25	0.75	2.00	1.45	0.118	6	HMFU45 SN12.2000 Z06-INCH	2248300	o		
2.6	2.75	1.00	2.50	1.70	0.118	6	HMFU45 SN12.2500 Z06-INCH	2248400	o		
2.6	2.75	1.00	2.50	1.70	0.118	8	HMFU45 SN12.2500 Z08-INCH	2248500	o		
3.1	3.25	1.00	2.50	1.70	0.118	7	HMFU45 SN12.3000 Z07-INCH	2248600	o		
3.1	3.25	1.00	2.50	1.70	0.118	10	HMFU45 SN12.3000 Z10-INCH	2248700	o		
4.1	4.25	1.50	3.75	2.20	0.118	8	HMFU45 SN12.4000 Z08-INCH	2248800	o		
4.1	4.25	1.50	3.75	2.20	0.118	12	HMFU45 SN12.4000 Z12-INCH	2248900	o		
5.1	5.25	1.50	3.75	2.45	0.118	10	HMFU45 SN12.5000 Z10-INCH	2249000	o		
5.1	5.25	1.50	3.75	2.45	0.118	16	HMFU45 SN12.5000 Z16-INCH	2249100	o		
6.1	6.25	2.00	5.00	2.45	0.118	12	HMFU45 SN12.6000 Z12-NCINCH	2249200	o		
6.1	6.25	2.00	5.00	2.45	0.118	20	HMFU45 SN12.6000 Z20-NCINCH	2249300	o		
8.1	8.25	2.50	6.00	2.45	0.118	18	HMFU45 SN12.8000 Z18-NCINCH	2249400	o		
10.1	10.25	2.50	7.50	2.45	0.118	20	HMFU45 SN12.10000 Z20-NCINCH	2248100	o		